





36 627 706

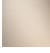

- avec structure CASCADE
- rosace 60 x 60 mm
- avec marquage froid
- tête de commande avec broche et douille à sectionner

	Chrome	36 627 706-00
	Platine brossé	36 627 706-06
	Dark Chrome	36 627 706-19
	Champagne brossé (Or 22cts)	36 627 706-46
	Champagne (Or 22cts)	36 627 706-47
	Dark Platinum brossé	36 627 706-99

Accessoires requis



- Robinet à encastrer 1/2" -** 35 607 970 90
- profondeur de montage max. 150 mm
 - profondeur de montage mini. 105 mm

36 627 706

mm [inches]

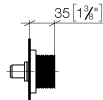
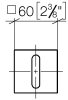

Certificats

DVGW_DW-
6501DN0116.

IAPMO_4976 (1).

LGA_29931.

WRAS_2010066.

LGA_29932.

36 627 706

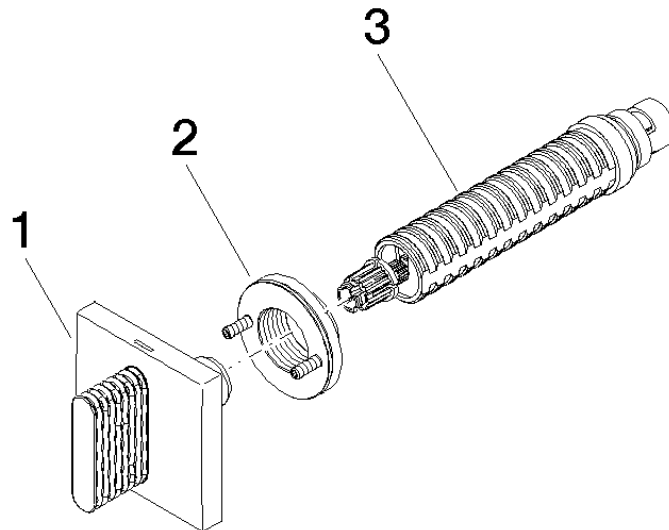

Liste des pièces de rechange

N°	Article Numéro	Désignation	Fréquence de montage	Délai de livraison
1	90 20 70 053 02-00	poignée (cold)	1	10
2	90 21 02 108 00 90	rondelle	1	2
3	90 90 03 143 00 90	tête céramique	1	2